

MATCHLINE - SEE SHEET NO. 6

LEGEND			
SYMBOL	DESCRIPTION	SYMBOL	DESCRIPTION
	EXISTING CONTOUR		PROPERTY LINE (APPROXIMATE)
	EXISTING DIRT/GRAVEL ROAD		APPROXIMATE LIMITS OF WASTE
	EXISTING FENCE		DRAINAGE AREA BREAKS
	EXISTING STREAM, POND		SPLASH PAD
	EXISTING TREELINE		EDGE OF CAP
	EXISTING MONITORING WELL		EROSION CONTROL MATTING

- NOTES:
- PROPOSED CONTOURS SHOWN ON THIS PLAN WITHIN THE PROPOSED EDGE ON CAP LIMITS REPRESENT THE PROPOSED SUBGRADE. THE 12-INCH INTERMEDIATE SOIL COVER LAYER SHALL BE PLACED OVER THE PROPOSED SUBGRADE. THE CONTRACTOR SHALL ALSO ENSURE THAT 6 INCHES OF DAILY SOIL COVER IS PROVIDED OVER WASTE PRIOR TO PLACING THE 12 INCH INTERMEDIATE SOIL COVER LAYER.
 - AT LOCATIONS WITHIN THE LIMITS OF THE PROPOSED EDGE OF CAP WHERE NO FILL IS SHOWN, THE EXISTING GROUND SURFACE WILL BE PREPARED TO RECEIVE THE CAP BY REMOVING ALL VEGETATION. THE 12-INCH INTERMEDIATE SOIL COVER LAYER SHALL BE PLACED OVER THE PREPARED SUBGRADE. THE CONTRACTOR SHALL ALSO ENSURE THAT 6 INCHES OF DAILY SOIL COVER IS PROVIDED OVER WASTE PRIOR TO PLACING THE 12 INCH INTERMEDIATE SOIL COVER LAYER.
 - SEE DRAWING NOS.3 AND 4 FOR THE LOCATIONS OF LEACHATE CUTOFF DRAINS AND LEACHATE SEEP COLLECTION DRAINS. THESE DRAINS SHALL BE INSTALLED BEFORE PLACEMENT OF THE 12-INCH INTERMEDIATE SOIL COVER.

- EXISTING RIPRAP LINED DITCHES LOCATED ON THE LANDFILL WITHIN THE LIMITS OF THE PROPOSED CAP SHALL BE REMOVED PRIOR TO CONSTRUCTION OF THE LEACHATE SEEP COLLECTOR DRAINS AND THE FINAL CAP. RIPRAP, IF SUITABLE QUALITY AND SIZE, MAY BE USED IN THE PROPOSED WORK WHERE ROCK RIPRAP IS REQUIRED. RIPRAP UNSUITABLE FOR USE SHALL BE INCORPORATED IN THE LANDFILL BUTTRESS AREA.
- CLEANOUTS SHALL BE PROVIDED FOR CAP DRAINAGE LAYER UNDERDRAINS EVERY 300 FEET ALONG THE UNDERDRAIN AND AT THE END OF EACH UNDERDRAIN. CLEANOUTS SHALL EXTEND 4 FEET ABOVE THE TOP OF THE SOIL COVER LAYER EXCEPT WHERE CLEANOUTS ARE ALONG CHANNELS A, B, AND B2.
- CAP DRAINAGE LAYER UNDERDRAINS SHALL BE CONSTRUCTED BELOW CHANNELS A, B, AND B2 ABOVE THE GEOSYNTHETIC CAP.

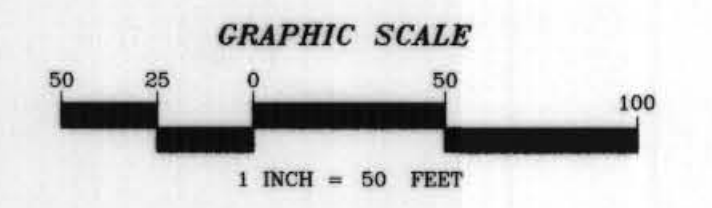

MAPPING REFERENCE:
TOPOGRAPHIC MAPPING GENERATED FROM AERIAL PHOTOGRAPHY DATED NOVEMBER 18, 1999 BY PHOTO SCIENCE, INC.

Revision	
Date	
No.	
97211112	CAD File No.
MBS	Drawn
DMK	Checked
Approved	NOTED
Scale:	
DEC. 2001	Date:
97211-006	Project No.

Potesta & Associates, Inc.
 ENGINEERS AND ENVIRONMENTAL CONSULTANTS
 2300 MacCorkle Ave. SE, Charleston, WV 25304
 TEL: (304) 342-1400 FAX: (304) 343-9031
 E-Mail Address: potesta@potesta.com

Owner: WEST VIRGINIA DEPARTMENT OF ENVIRONMENTAL PROTECTION
JACKSON COUNTY SANITARY LANDFILL
 RIPLEY, WEST VIRGINIA
 LANDFILL CLOSURE ASSISTANCE PROGRAM

FINAL CAP & SURFACE WATER PLAN

Title: **5**
 Drawing No.

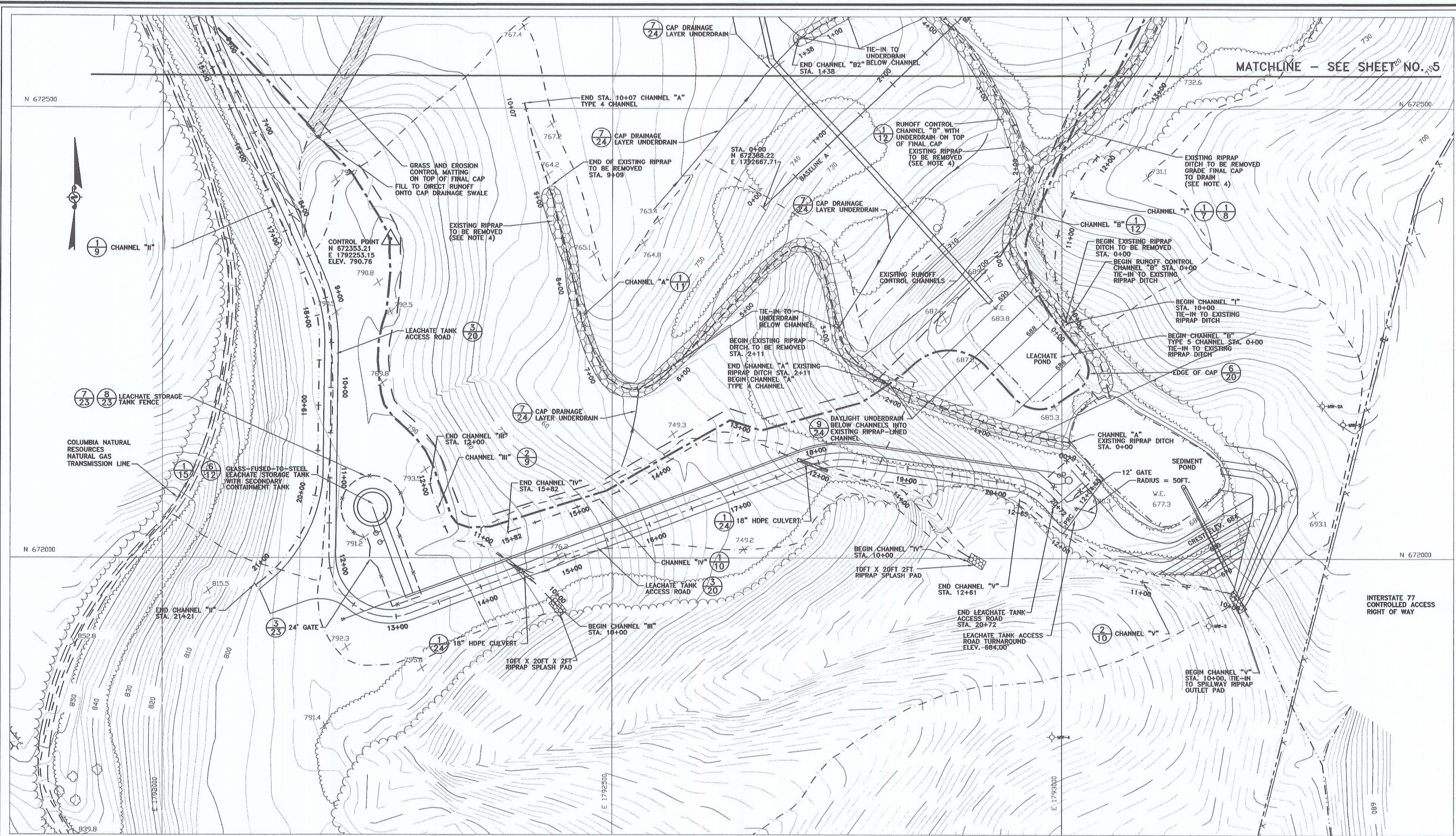

MATCHLINE - SEE SHEET NO. 5

N 672500
N 672000



LEGEND			
SYMBOL	DESCRIPTION	SYMBOL	DESCRIPTION
1000	EXISTING CONTOUR	- - - - -	PROPERTY LINE (APPROXIMATE)
---	EXISTING DIRT/GRAVEL ROAD	---	APPROXIMATE LIMITS OF WASTE
---	EXISTING FENCE	---	DRAINAGE AREA BREAKS
---	EXISTING STREAM, POND	---	SPLASH PAD
---	EXISTING TREELINE	---	EDGE OF CAP
○ MW-1	EXISTING MONITORING WELL	---	EROSION CONTROL MATTING

- NOTES:
- PROPOSED CONTOURS SHOWN ON THIS PLAN WITHIN THE PROPOSED EDGE ON CAP LIMITS REPRESENT THE PROPOSED SUBGRADE. THE 12-INCH INTERMEDIATE SOIL COVER LAYER SHALL BE PLACED OVER THE PROPOSED SUBGRADE. THE CONTRACTOR SHALL ALSO ENSURE THAT 6 INCHES OF DAILY SOIL COVER IS PROVIDED OVER WASTE PRIOR TO PLACING THE 12 INCH INTERMEDIATE SOIL COVER LAYER.
 - AT LOCATIONS WITHIN THE LIMITS OF THE PROPOSED EDGE OF CAP WHERE NO FILL IS SHOWN, THE EXISTING GROUND SURFACE WILL BE PREPARED TO RECEIVE THE CAP BY REMOVING ALL VEGETATION. THE 12-INCH INTERMEDIATE SOIL COVER LAYER SHALL BE PLACED OVER THE PREPARED SUBGRADE. THE CONTRACTOR SHALL ALSO ENSURE THAT 6 INCHES OF DAILY SOIL COVER IS PROVIDED OVER WASTE PRIOR TO PLACING THE 12 INCH INTERMEDIATE SOIL COVER LAYER.
 - SEE DRAWING NOS.3 AND 4 FOR THE LOCATIONS OF LEACHATE CUTOFF DRAINS AND LEACHATE SEEP COLLECTION DRAINS. THESE DRAINS SHALL BE INSTALLED BEFORE PLACEMENT OF THE 12-INCH INTERMEDIATE SOIL COVER.

- EXISTING RIPRAP LINED DITCHES LOCATED ON THE LANDFILL WITHIN THE LIMITS OF THE PROPOSED CAP SHALL BE REMOVED PRIOR TO CONSTRUCTION OF THE LEACHATE SEEP COLLECTOR DRAINS AND THE FINAL CAP. RIPRAP, IF SUITABLE QUALITY AND SIZE, MAY BE USED IN THE PROPOSED WORK WHERE ROCK RIPRAP IS REQUIRED. RIPRAP UNSUITABLE FOR USE SHALL BE INCORPORATED IN THE LANDFILL BUTTRESS AREA.
- CLEANOUTS SHALL BE PROVIDED FOR CAP DRAINAGE LAYER UNDERDRAINS EVERY 300 FEET ALONG THE UNDERDRAIN AND AT THE END OF EACH UNDERDRAIN. CLEANOUTS SHALL EXTEND 4 FEET ABOVE THE TOP OF THE SOIL COVER LAYER EXCEPT WHERE CLEANOUTS ARE ALONG CHANNELS A, B, AND B2.
- CAP DRAINAGE LAYER UNDERDRAINS SHALL BE CONSTRUCTED BELOW CHANNELS A, B, AND B2 ABOVE THE GEOSYNTHETIC CAP.

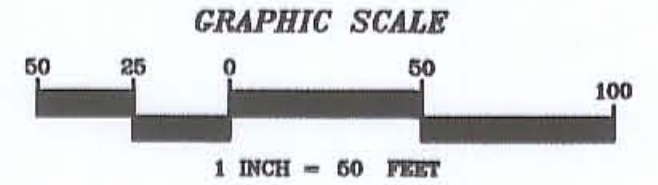

MAPPING REFERENCE:
TOPOGRAPHIC MAPPING GENERATED FROM AERIAL PHOTOGRAPHY DATED NOVEMBER 18, 1999 BY PHOTO SCIENCE, INC.

Revision	
Date	
No.	
97211J12	CAD File No.
MBS	Drawn
DMK	Checked
Approved	NOTED
Scale:	JANUARY 2002
	Date
97211-006	Project No.
Potesta & Associates, Inc. ENGINEERS AND ENVIRONMENTAL CONSULTANTS 2800 MacCorkle Ave. SE, Charleston, WV 25304 TEL: (304) 342-1400 FAX: (304) 343-9031 E-Mail Address: potesta@potesta.com	
WEST VIRGINIA DEPARTMENT OF ENVIRONMENTAL PROTECTION JACKSON COUNTY SANITARY LANDFILL RELEY, WEST VIRGINIA LANDFILL CLOSURE ASSISTANCE PROGRAM	
FINAL CAP & SURFACE WATER PLAN	
Title	6
Drawing No.	