

LEGEND

- PERMANENT RIGHT-OF-WAY
- TEMPORARY RIGHT-OF-WAY
- TOPSOIL SEGREGATION AREA
- ADDITIONAL TEMPORARY WORK SPACE
- WETLAND
- STREAM
- LIMITS OF DISTURBANCE
- CONTOUR
- SILT FENCE
- SILT SOCK
- ROCK CONSTRUCTION ENTRANCE
- TRENCH PLUG
- WATER BAR
- TEMPORARY SLOPE BREAKER

WATERBODY IMPACT		
WATERBODY #	TEMP. IMPACT	PERMANENT IMPACT
-	0.55 ACRES	0.00 ACRES

WATERBODY IMPACT

WATERBODY CONSTRUCTION NOTES:

1. CROSSING TO BE COMPLETED VIA THE USE OF A COFFERDAM.
2. CONSTRUCTION TO BE PERFORMED IN LOW FLOW PERIODS. FLOW SHALL BE MAINTAINED.
3. RIP RAP (OR OTHER NON-ERODIBLE MATERIALS) TO BE PLACED IN SEMICIRCLE ALONG SIDE OF STREAM. ABOVE THE ORDINARY HIGHWATER MARK.
4. DISCHARGED WATER THROUGH AN APPROVED SEDIMENT TRAPPING DEVICE.
5. STABILIZE WATER WATERBODY BANKS AND INSTALL TEMPORARY SEDIMENT BARRIERS WITHIN 24-HOURS OF COMPLETING IN-STREAM CONSTRUCTION ACTIVITIES.
6. RETURN ALL WATERBODY BANKS TO PRE-CONSTRUCTION CONTOURS OR TO A STABLE ANGLE OF REPOSE AS APPROVED BY THE ENVIRONMENTAL INSPECTOR. FILL BELOW THE ORDINARY HIGH WATER MARK SHOULD BE AVOIDED.
7. INSTALL TRENCH PLUGS AND WATERBARS AS DIRECTED BY THE APPROVED EROSION AND SEDIMENTATION CONTROL PLAN ON BOTH SIDES OF THE WATERWAY, AND AS DEPICTED ON THIS PLAN.
8. PIPELINE SHALL BE WEIGHTED WITH CONCRETE COATING IN THE RIVER CROSSING TO ACHIEVE NEGATIVE BUOYANCY.
9. UPON COMPLETION OF CONSTRUCTION WITHIN THE COFFERDAM. THE COFFERDAM WILL BE RELOCATED TO OPPOSITE SIDE OF WATERBODY FOR COMPLETION OF PIPELINE CONSTRUCTION.

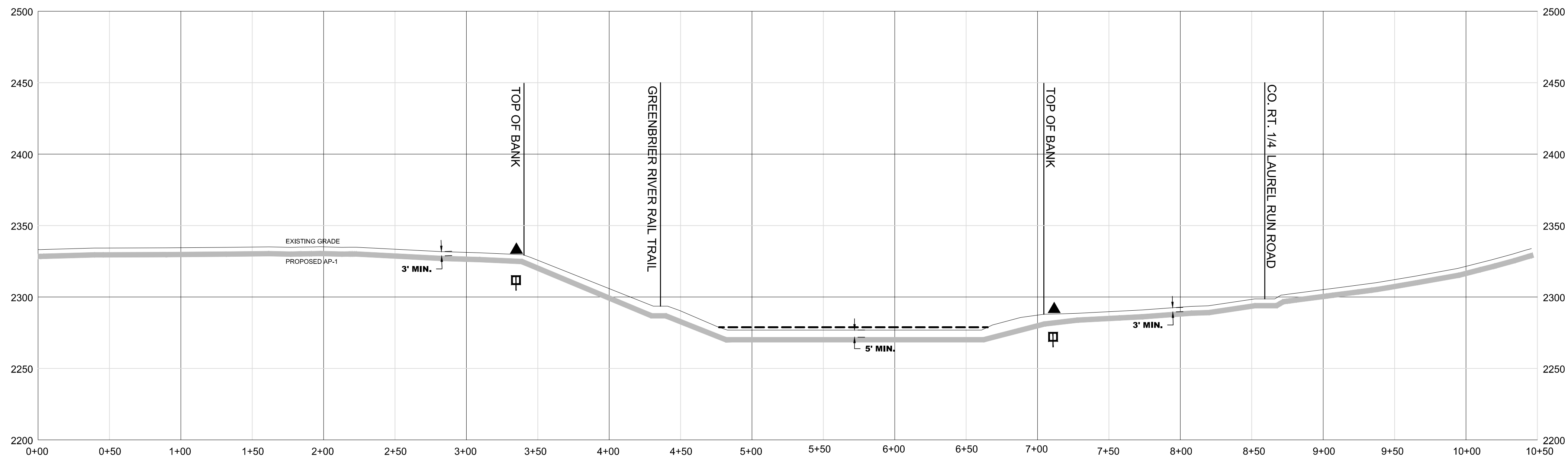

STREAM CROSSING PROFILE

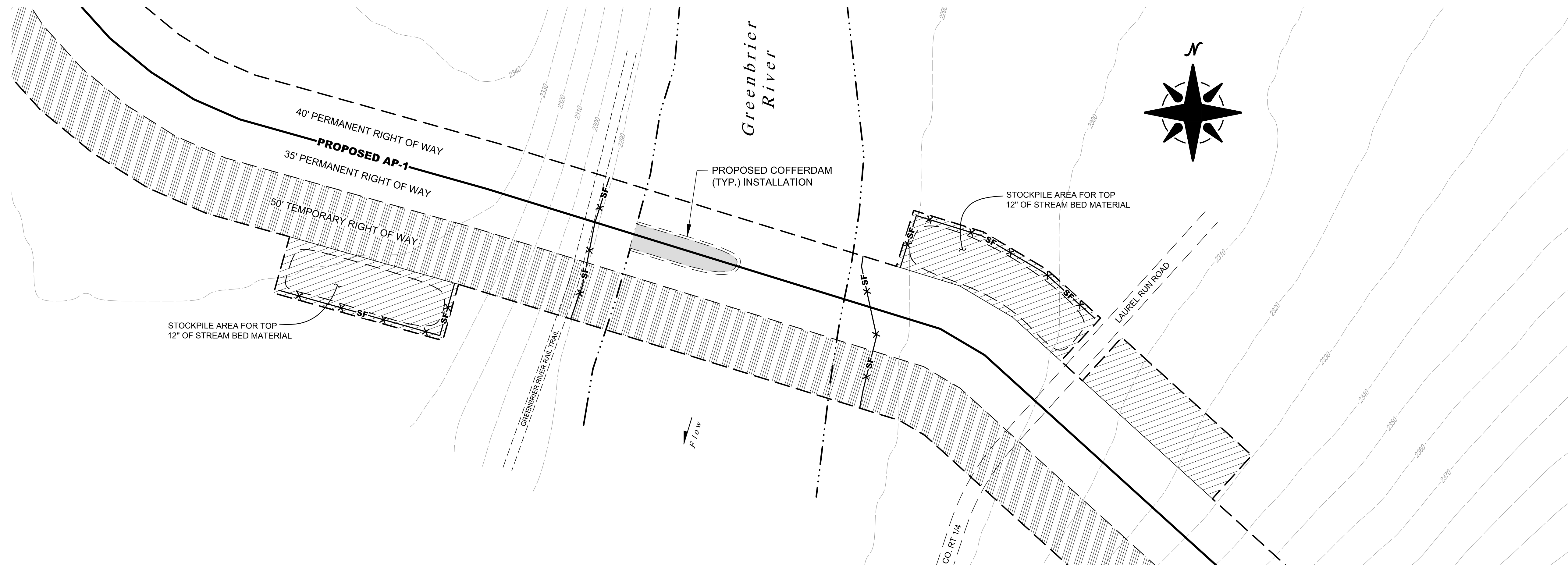

PLAN VIEW



GENERAL NOTES AND COMMENTS:

REFERENCE
 ELEVATION DATA FROM THE USGS GIS DATA CLEARING HOUSE.
 PIPELINE SURVEY INFORMATION PROVIDED BY GAI CONSULTANTS.
 STREAM AND WETLAND DATA COLLECTED BY NATIONAL RESOURCE GROUP, LLC.
 MAPPING DATUM-UTM17-NAD 83
 CONTOUR INTERVAL - 10 FEET

SYM.	DATE	BY	REVISION INFORMATION	PROJECT/TASK	APP.
△	1/06/17	ALC	ISSUED FOR REVIEW - ALIGNMENT RELOCATION		
△	4/5/16	RLR	ISSUED FOR REVIEW		

SEAL



DRAWN:	RLR	4/5/16
CHECKED:	RVS / DLM	4/5/16
APP. FOR BID:		
APP. FOR CONST.:		
SCALE:	AS SHOWN	

Atlantic Coast Pipeline, LLC
 925 White Oaks Blvd. Bridgeport, West Virginia 26330 / 681-842-8000

TITLE: AP-1 SITE SPECIFIC PLAN FOR GREENBRIER RIVER

DISTRICT: HUNTERSVILLE	COUNTY: POCAHONTAS	STATE: WV	GROUP:	DWG. NO.:	REV.:
DIR/FILE: DOM/ACP/Site Specific/Greenbrier River					B